

Clive School Term 1 2019

Newsletter No2 April 8th

Well done, the band of toilers, keep on working !
Ka mahi te hukuroa i ana mahi !

A very busy term for everybody in the school community...**Friends of the School** with weekly fundraising and Food fair our unsung work alcoholics. Our Governing **Board of Trustees** who ensure the school meets its requirements and provides the best it can for students. **Afcare** deserve a mention as well daily they look after the early birds and the late to be collected a never ending role that is important for many families

29th April

1st

2nd

3rd

7th

10th

13th

14th

17th

Term 2 school starts

School opens

iWay

iWay

iWay

Parents yr 3 & 4

Assembly room 1

Board Trustees Meeting

Parent Evening at school

Assembly room 2

All staff at Clive School well done an eleven week term plenty of challenges changes and great programmes of work in classes with children

The Explorers are well underway they have every opportunity to make the best of a wonderful environment that stimulates and empowers them as learners. We will open a new explorer class at the start of term 2 with Mr Bryant.

A huge variety of **Sporting, Cultural and Learning programmes** have been going on since the start of the year. **Engaging students** means getting kids excited about content, interests and curricula. **Empowering students** means giving kids the knowledge and skills to pursue **their passions, their interests and their future**

Kids need to be empowered
not just engaged

So well done all Clive Kids
a great first term



Board of Trustees
CLIVE SCHOOL

Are you ready to serve your
community...consider standing !!



Clive School Procedure in Case of Emergency



Fire Emergency Response Plan Updated 2019 April

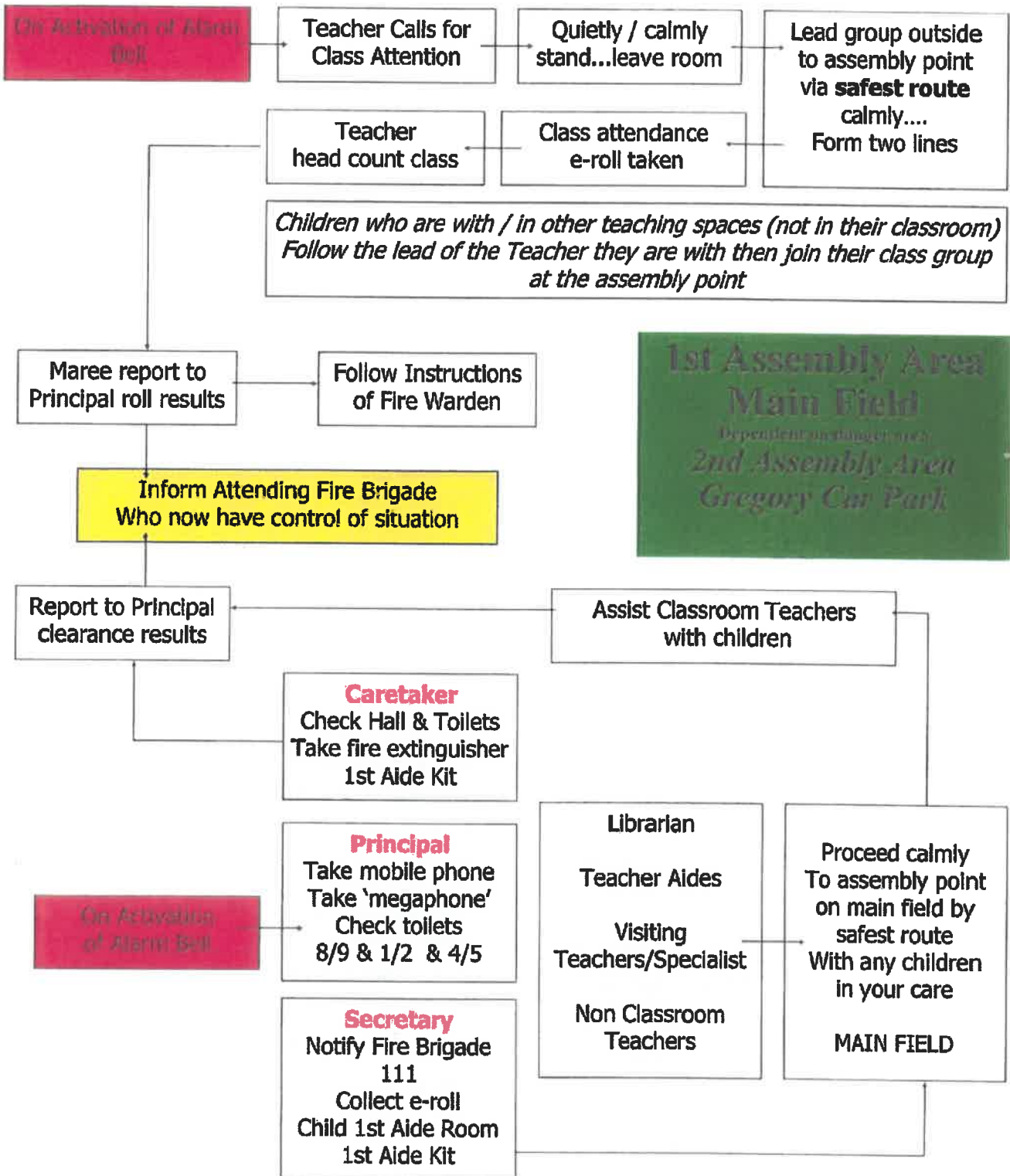



Clive School
Earthquake



STOP

DROP

COVER

HOLD

Then

Listen to the adult in the room

**all ADULTS in the school
need to know the next action
if it shakes for a minute or more
or we can't stand up
we can evacuate**



Clive School LOCK DOWN



**In case of an un welcome personal ...
dangerous chemical spill, dangerous animal...
Etc..on the school site
or on the advice of the Police or Principal**

teachers will be notified of 'lock down' by
school app alert / broadcast over TV
or the continuous ringing of the school bell to go inside ...

If you suspect
any of the
above
at school

Please inform the
office
Principal
to take next step
Or activate the
Procedure
yourself

Remain as a class group in classroom
Lock window and exit doors
**Sit as a class on mat, read a story, sing a song, do
maths ... Remain on floor**
**only open the room to Police or
on advice from Principal**
Do not allow children to exit, for any reason!!!
**If outside, then return to the
nearest classroom room asap...**

The Principal will give all clear to each room...to return to normal
any parents who arrive on site will remain on site in safe area

Once the lock down has ended ...
assemble in Hall for a 'school de brief'

At which time information will be ready to be sent home
with the children

A full review of the above will be held after the event



CLIVE

TSUNAMI EVACUATION ZONES

WHAT WOULD
YOU DO
IN AN EMERGENCY?

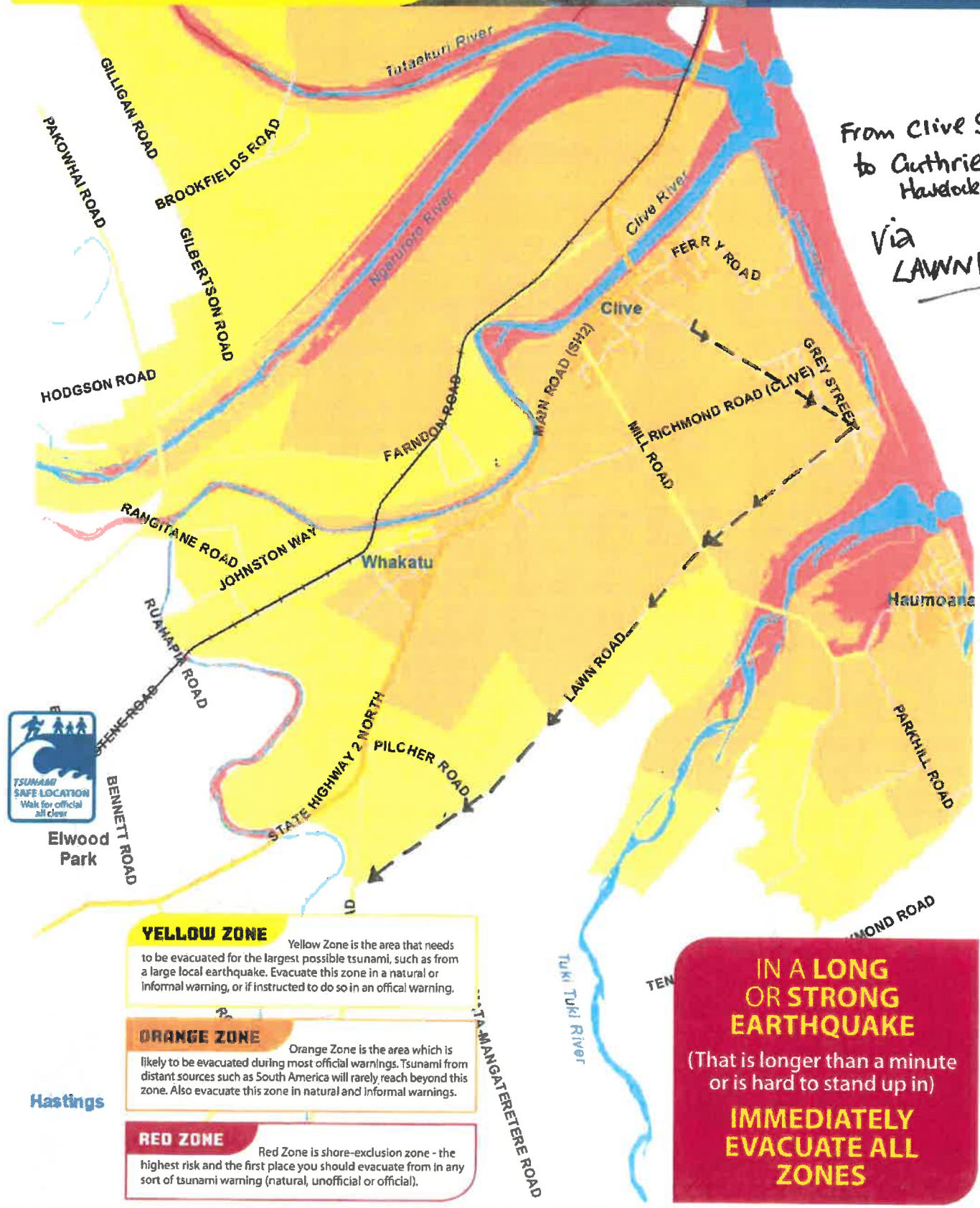

*From Clive School
to Cuthrie Park
Hawke's Bay
via
LAWN ROAD*



Elwood Park

- YELLOW ZONE** Yellow Zone is the area that needs to be evacuated for the largest possible tsunami, such as from a large local earthquake. Evacuate this zone in a natural or informal warning, or if instructed to do so in an official warning.
- ORANGE ZONE** Orange Zone is the area which is likely to be evacuated during most official warnings. Tsunami from distant sources such as South America will rarely reach beyond this zone. Also evacuate this zone in natural and informal warnings.
- RED ZONE** Red Zone is shore-exclusion zone - the highest risk and the first place you should evacuate from in any sort of tsunami warning (natural, unofficial or official).

IN A LONG OR STRONG EARTHQUAKE
(That is longer than a minute or is hard to stand up in)
IMMEDIATELY EVACUATE ALL ZONES

Hastings

Clive School Evacuation Procedures

We evacuate everyone to the main playing field.....**initially**

Teachers if coming from classroom and are able to please bring e-device (phone) to take the roll via etap

If adverse weather conditions; same evacuation point – next step decision made by Principal based on safety decisions (see below)

| Students are your focus (Orange vest) | Decisions Principal (Green Vest) | Attendance (yellow vest) | Safety (yellow vest) | Students Support Staff (orange vest) | No Child leaves the school site unless the Principal has given permission. |
|--|---|--|--|---|---|
| Class teachers Settle your students take the roll via etap on cell phone or device Teachers are to go to Joann (yellow vest) Report on roll numbers the students not present. Keep all your students calm listening for announcements and instructions | Mega sound system Responsible for Overall coordination Building safety Communication Use whistle sound system siren for attention Coordinate next steps; Safest location Txt info to parents Txt info to CD Responsible for releasing staff /students replace wit support staff as needed | Joann (yellow vest) Lock front door check/clear Check sick bay Check staffroom Bring; e-device for roll e-device of visitors log 1 st aide kit Check of classes as the report Report Roll to Principal | Mary-Lou (yellow vest) Bring 1 st aide kit Fire extinguisher Check Safety of buildings grounds for hazards Advise principal of Check driveway clear | Support you delegated student Support teacher of class Supervise toileting use pool area if needed if safe Help others as directed | Mobile e-device is the main roll Take photo of who child went with as a record Staff dismissed by the Principal |

If adverse weather the most likely next step if deemed safe to use is the Hall

If it shakes for a minute or we cant stand (Principal will make call) we will alert via App

Then it is to car evacuation assembly point in orderly as fashion

And all move to safe site in Havelock North @ Gutherie Park (staff bring what is listed above same expectations)

Staff make it a habit of parking facing outwards or on roadway for fast fill and departure to Havelock North. Via School Road ,Lawn Road ,Havelock Nth Road